

BME ELITE™ CONTINUOUS COMPRESSION IMPLANT

Product Overview



Continuous Active Compression

The BME ELITE™ Continuous Compression Implants were compared to the following constructs: locking titanium midfoot compression plates, with and without 4.0 mm lag screws, and crossing 4.0 mm screws. These fixation combinations are commonly used in various arthrodesis sites. Compression measurements were taken using Tekscan® pressure maps placed between bicortical Sawbone® blocks. Measurements were taken before and after repetitive loading of 100 cycles at 2 mm displacement.

Constructs using the BME ELITE Implants provided significantly more compression than a locking titanium midfoot compression plate with and without a 4.0 mm lag screw and crossing 4.0 mm lag screws.

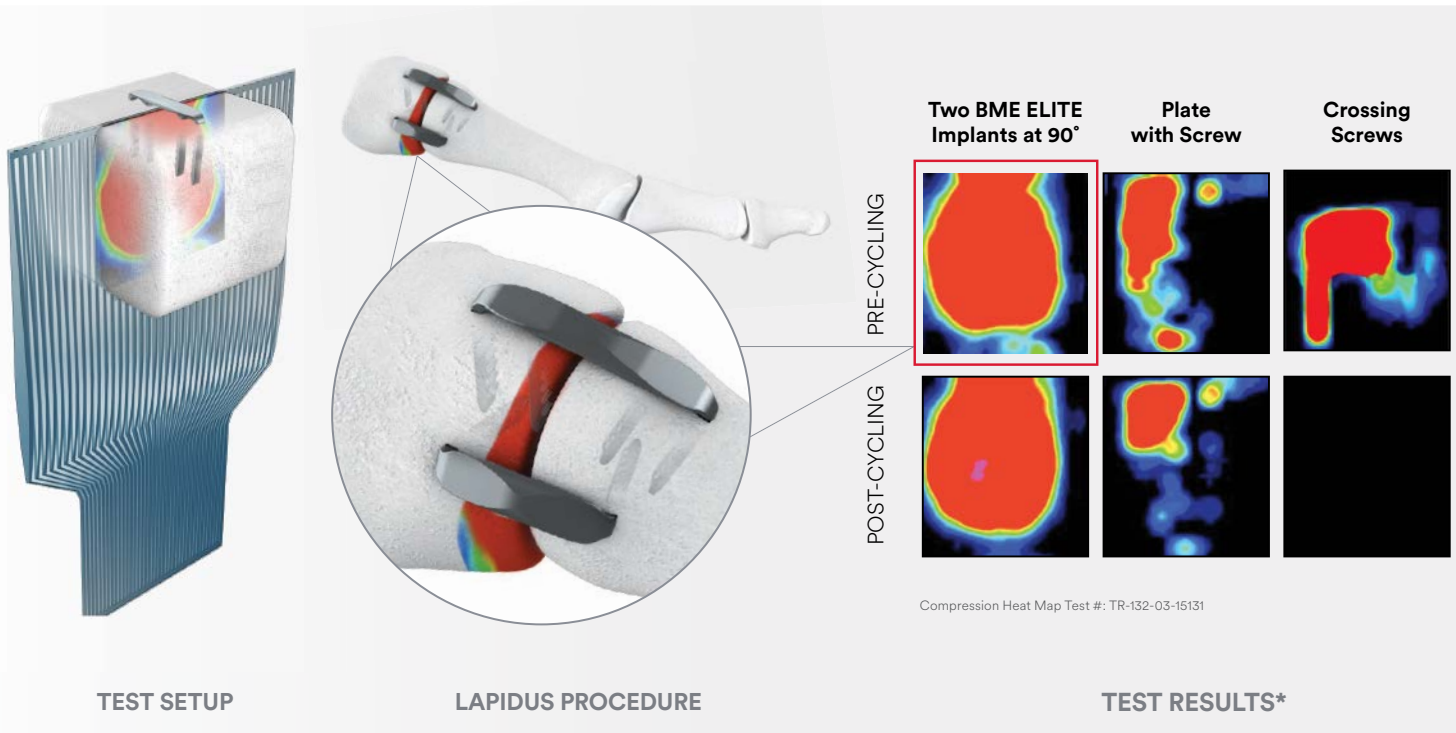

Compression Before and After Repetitive Loading (N)¹

(100 Cycles at 2 mm Displacement)

■ Pre-Cycling ■ Post-Cycling ■ Pre-Cycling ■ Post-Cycling

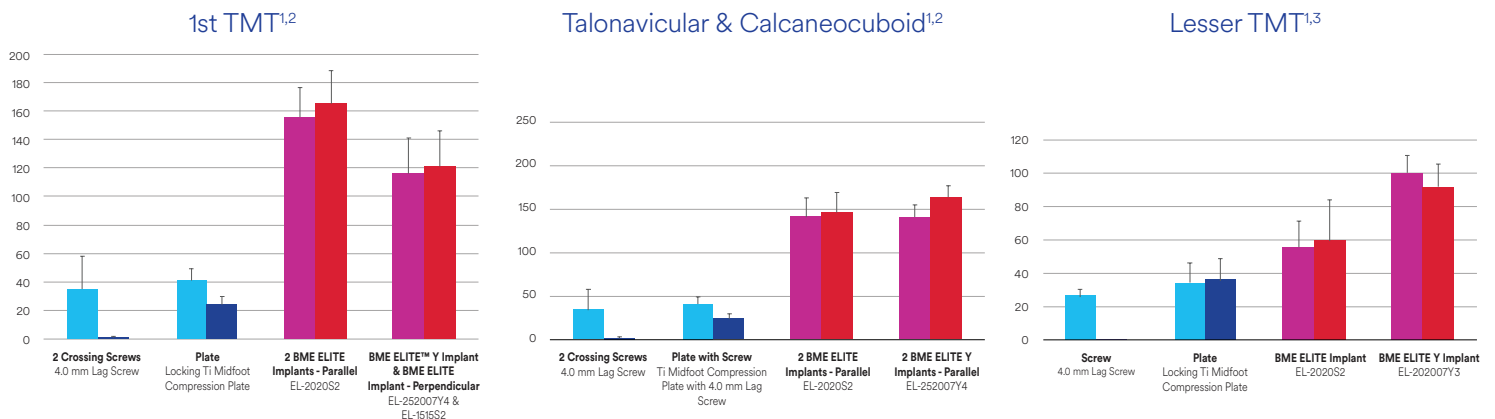

¹Bench test results may not necessarily be indicative of clinical performance.
²1N=0.225 Pounds-force.

References: 1.Elite Straight Pre- and Post-Cycling Tekscan Compression Test Report. 2/9/2015. Windchill Document #0000285507. 2: Elite-S and Elite-Y Construct Stability Testing in 4-Point Bend Test Report. 4/4/2019. Windchill Document #0000292716. 3: Elite Y-Series (Rev X10) Construct Stability Test Report. 5/10/2016. Windchill Document #0000285106. 4: Elite Straight Cyclical Torsion Test Report. 2/17/2016. Windchill Document #0000285082. 5: Elite-S and Elite-Y Construct Stability Testing in Torsion Test Report. 4/10/2019. Windchill Document #0000292717. 6. Elite Straight Pull-Out Tests. 12/16/2014. Windchill Document #0000285477. 7. Elite "Y" Series (Rev x10) Pull-out Strength Test Report. 4/28/2016. Windchill Document #0000285482.

Construct Rigidity

Construct rigidity, shown by the amount of force required to displace the constructs 2 mm, was tested using a four-point bending apparatus. Measurements were taken for the first and 100th cycle of repetitive loading.

BME ELITE and BME ELITE™ Y Implants were tested against a leading locking titanium midfoot plate and 4.0 mm lag screw. The graph to the right shows the results.

Construct Rigidity at 1st & 100th Cycle (N)
(100 Cycles at 2 mm Displacement)^{1,3}

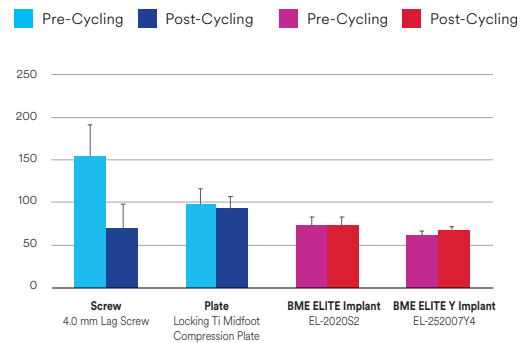

Torsional Stability

Torsional stability is the amount of force required to torque the constructs 15 degrees. Fixation combinations simulated arthrodesis of the talonavicular joint. Measurements were taken for the first and 100th cycle of repetitive loading.

Two BME ELITE Implants in parallel (both a standard pair and a Y pair) were tested against two 4.0 mm screws and a locking titanium midfoot compression plate with a lag screw. The graph to the right shows the results.

Torsional Stability (Torque) at 1st & 100th Cycle
(Ncm)(100 Cycles at 15° Displacement)^{4,5}

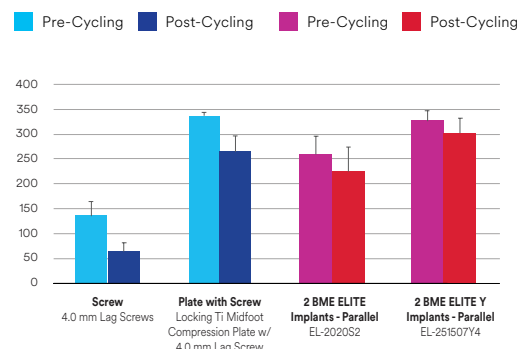

¹IN=0.225 Pounds-force

Extra-wide, low-profile bridge (1.5 mm)

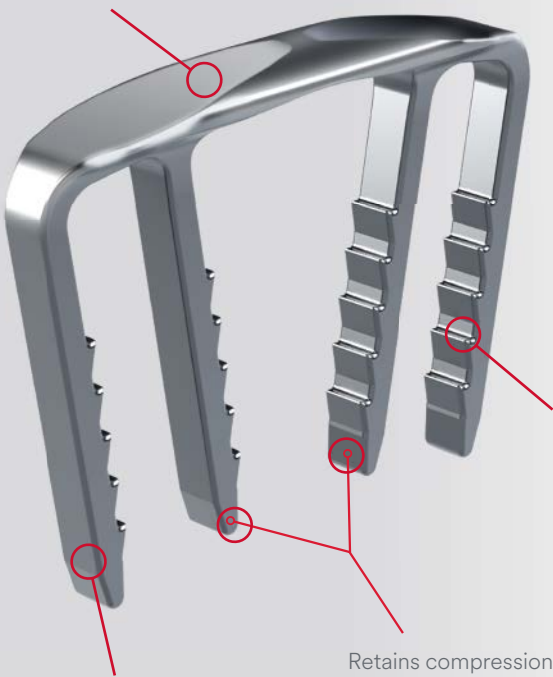

Barbed legs provide secure fixation^{6,7}

Retains compression after repetitive loading¹

High strength, stiffness and rotational stability for high-load applications¹



Pre-sterilized, fully disposable system. Ready for use—no heating, freezing, or spreading required.



BME ELITE Continuous Compression Implants

BME ELITE Continuous Compression Implant			
Implant	Bridge*	Legs*	No. of Legs
EL-1515S2	15	15	2
EL-1815S2	18	15	2
EL-1818S2	18	18	2
EL-2015S2	20	15	2
EL-2020S2	20	20	2
EL-2520S2	25	20	2
EL-2520S4	25	20	4
EL-3020S4	30	20	4

BME ELITE Y Continuous Compression Implant			
Implant	Bridge*	Legs*	No. of Legs
EL-201507Y3	20	15	3
EL-202007Y3	20	20	3
EL-251507Y4	25	15	4
EL-252007Y4	25	20	4
EL-301507Y4	30	15	4
EL-302007Y4	30	20	4

*Sizes in millimeters.
Leg configuration for 3 and 4 leg implants are the same.

2-Legged BME ELITE Implant

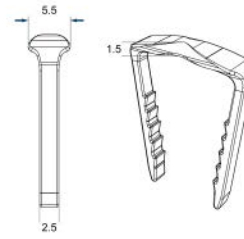

4-Legged BME ELITE Implant

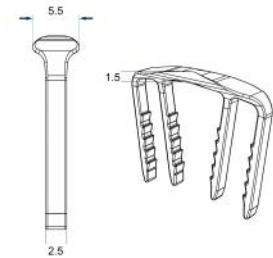

3-Legged BME ELITE Y Implant

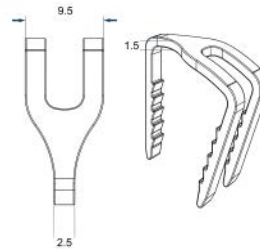

4-Legged BME ELITE Y Implant

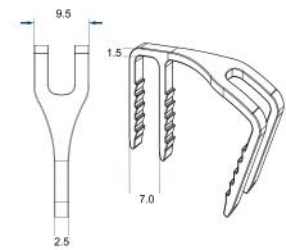

Degree of curvature of BME ELITE Y Implants in the closed position is 20°

ALL SIZES IN MILLIMETERS

Corresponding Drill/Drill Guide Kits

Part Number	Drill Bit Size	Drill Guides*	Pull Pins	Tamp	K-Wires	Depth Gauge
DK-300	3.0 mm	–	4xLP-300	EL-TAMP	4x1.6 mm	Included
EL-DTS	–	15, 18, 20, 25, 30	–	–	–	–
EL-DTY	–	20, 25, 30	–	–	–	–

*Sizes in millimeters.

DK-300



EL-DTS



EL-DTY



Manufactured by:
Synthes GmbH
Eimattstrasse 3
4436 Oberdorf
Switzerland

Tel: +41 61 965 61 11
Fax: +41 61 965 66 00

© DePuy Synthes 2021. All rights reserved.
127248-210527 DSUS/EMEA DV

Please refer to the instructions for use for a complete list of indications, contraindications, warnings and precautions.

Please also refer to the package insert(s) or other labeling associated with the devices identified in this document for additional information.

CAUTION: Federal Law restricts these devices to sale by or on the order of a physician. Some devices listed in this sales aid may not have been licensed in accordance with Canadian law and may not be for sale in Canada.

Please contact your sales consultant for items approved for sale in Canada.

Not all Products may currently be available in all markets.

Third party trademarks used herein are the trademarks of their respective owners