

HARMONIC FOCUS[®]+ Shears

Assembly Guide

Assembly



Using aseptic technique, remove the instrument from the packaging



While holding the Hand Piece, attach the instrument by rotating it onto the Hand Piece in a clockwise rotation

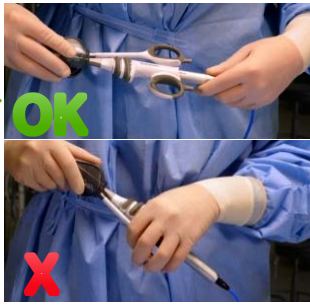

Use the Grey Torque Wrench to tighten the instrument onto the Hand Piece. Turn the wrench clockwise while holding the Hand Piece until it clicks twice.*



Remove the Torque Wrench from the instrument. Do not discard the disposable Torque Wrench until the completion of the surgical case.

*Failure to follow these assembly steps may cause inadvertent damage to the HARMONIC[®] Shears or reusable Hand Piece.

Pre-Run Testing

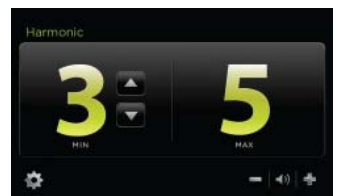
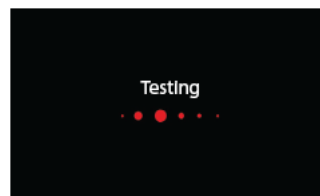

Connect the assembled Hand Piece and instrument to the generator and turn the generator power on. Follow On-Screen Instructions to complete initiation. The test prompt screen appears when the initiation sequence is complete. Activate the instrument (by depressing either one of the triggers) with the **jaws open** for 2 seconds to run test until the HARMONIC[®] ready screen is displayed.

Re-Attaching the Torque Wrench

Close the clamp arm and place the Grey Torque Wrench over the distal end of the instrument.



For all product details, including a complete list of warnings and precautions, please reference the Instructions for Use and Generator Operator's Manual.